

【帳票作成】

• 主要点計算書 (xlsx)

| 線形名 | ○○路線-線形2 (主測点間隔20m、S型、卵型) | | | | | | | | |
|-------|---------------------------|-------------|--------------|--------------|-------------|-------------|------|------|---------|
| 主要点名称 | 測点 | 累加距離標 | X座標 | Y座標 | 接線角 | 要素長 | 始点半径 | 終点半径 | パラメータ A |
| BP | 0+00.000000 | 0 | -5514.745986 | -16548.53373 | 11.58557425 | 64.28571429 | | 350 | 150 |
| BC1 | 3+04.285714 | 64.28571429 | -5451.428147 | -16537.56071 | 6.323715069 | 185.8540027 | 350 | 350 | |
| KE1-2 | 12+10.139717 | 250.139717 | -5269.955918 | -16565.94166 | 335.8991187 | 64.28571429 | 350 | | 150 |
| KA2-1 | 15+14.425431 | 314.4254312 | -5213.011734 | -16595.72279 | 330.6372596 | 90 | | -250 | -150 |
| BC2 | 20+04.425431 | 404.4254312 | -5132.185917 | -16635.01513 | 340.9505032 | 44.80350455 | -250 | -250 | |
| KA3-1 | 22+09.228936 | 449.2289358 | -5088.755507 | -16645.77555 | 351.2187138 | 8.1 | -250 | -200 | -90 |
| BC3 | 22+17.328936 | 457.3289358 | -5080.730432 | -16646.87141 | 353.3071457 | 29.83617955 | -200 | -200 | |
| KE3-2 | 24+07.165115 | 487.1651153 | -5050.94848 | -16648.12967 | 1.854455821 | 72 | -200 | | -120 |
| KA4-1 | 27+19.165115 | 559.1651153 | -4979.885228 | -16637.21625 | 12.16769982 | 70 | | 280 | 140 |
| BC4 | 31+09.165115 | 629.1651153 | -4910.950556 | -16625.33309 | 5.00572465 | 101.1321998 | 280 | 280 | |
| EP | 36+10.297315 | 730.2973151 | -4810.803961 | -16634.69659 | | | | | |

• IP 諸元計算書 (xlsx): 新規で IP 法で作図した場合、下記のように出力 (IP 点が無い場合、出力なし)

| 線形名 | 線形 (1) | | | | |
|-------|-------------|-------------|------------|------------|-----------|
| IP 点名 | X座標 | Y座標 | 接線長 | 接線角 | 交角 |
| BP | 23775.88508 | 314311.2223 | | | |
| IP-1 | 23675.73426 | 314495.2558 | 209.519781 | 118.554973 | |
| IP-2 | 23492.63848 | 314579.6937 | 201.627897 | 155.242383 | 36.68741 |
| EP | 23442.1304 | 314671.6371 | 104.903157 | 118.781678 | 36.460705 |

• 中間点計算書 (xlsx, csv)

| 線形名 | oo路線-線形2 (主測点間隔20m、S型、卵型) | | | | | | | |
|-------------|---------------------------|--------------|--------------|-------------|-------------|-------------|-------------|-------------|
| 測点 | 累加距離標 | X座標 | Y座標 | 標高 | 接線角 | 単距離 | 弦接線角 | 区間弦長 |
| ka1-1 | 0 | -5514.745986 | -16548.53373 | 83.55004 | 11.58557009 | | | |
| no.1 | 20 | -5495.141723 | -16544.57519 | 82.6123177 | 11.07627427 | 20 | 11.41580492 | 19.99992976 |
| no.2 | 40 | -5475.470705 | -16540.96587 | 81.67459539 | 9.548386819 | 20 | 10.39721419 | 19.99940303 |
| no.3 | 60 | -5455.684858 | -16538.05825 | 80.75536124 | 7.001907729 | 20 | 8.360032718 | 19.99834956 |
| ke1-1 | 64.28571429 | -5451.428147 | -16537.56071 | 80.56482392 | 6.323712788 | 4.28571429 | 6.666707925 | 4.285689256 |
| no.4 | 80 | -5435.775873 | -16536.181 | 79.88597139 | 3.751249217 | 15.71428571 | 5.037480985 | 15.71296586 |
| no.5 | 100 | -5415.792207 | -16535.44326 | 79.06694163 | 0.477204673 | 20 | 2.11422696 | 19.99727902 |
| no.6 | 120 | -5395.799025 | -16535.84803 | 78.29827197 | 357.2031601 | 20 | 358.8401824 | 19.99727903 |
| no.7 | 140 | -5375.861593 | -16537.39399 | 77.5799624 | 353.9291156 | 20 | 355.5661379 | 19.99727902 |
| no.8 | 160 | -5356.044995 | -16540.07608 | 76.89352478 | 350.655071 | 20 | 352.2920933 | 19.99727903 |
| no.9 | 180 | -5336.413922 | -16543.88556 | 76.20760295 | 347.3810265 | 20 | 349.0180488 | 19.99727902 |
| no.10 | 200 | -5317.032456 | -16548.80998 | 75.53354568 | 344.106982 | 20 | 345.7440042 | 19.99727902 |
| no.11 | 220 | -5297.963867 | -16554.83328 | 74.96236107 | 340.8329374 | 20 | 342.4699597 | 19.99727903 |
| no.12 | 240 | -5279.270404 | -16561.93578 | 74.5130827 | 337.5588929 | 20 | 339.1959152 | 19.99727902 |
| ke1-2 | 250.1397175 | -5269.955918 | -16565.94166 | 74.33187435 | 335.8989985 | 10.13971749 | 336.7289457 | 10.1393629 |
| no.13 | 260 | -5261.010057 | -16570.08789 | 74.18571057 | 334.4086393 | 9.86028251 | 335.1331869 | 9.860004407 |
| no.14 | 280 | -5243.160689 | -16579.1072 | 73.98024468 | 332.1460706 | 20 | 333.1924701 | 19.99869613 |
| no.15 | 300 | -5225.594833 | -16588.66883 | 73.88482046 | 330.9020936 | 20 | 331.4391988 | 19.99960279 |
| ka1-2+ka2-1 | 314.4254318 | -5213.011733 | -16595.72279 | 73.82972207 | 330.6371412 | 14.42543178 | 330.7254587 | 14.42541807 |
| no.16 | 320 | -5208.152691 | -16598.4551 | 73.80842983 | 330.6767082 | 5.57456822 | 330.6503303 | 5.574568108 |
| no.17 | 340 | -5190.662399 | -16608.15474 | 73.7320392 | 331.4699144 | 20 | 330.9884284 | 19.99983589 |
| no.18 | 360 | -5172.95674 | -16617.454 | 73.65564856 | 333.2817123 | 20 | 332.2909293 | 19.99916234 |
| no.19 | 380 | -5154.890076 | -16626.02804 | 73.57925793 | 336.1121018 | 20 | 334.612021 | 19.99796208 |
| no.20 | 400 | -5136.35621 | -16633.53438 | 73.50287559 | 339.961083 | 20 | 337.9517034 | 19.99623516 |
| ke2-1 | 404.4254318 | -5132.185916 | -16635.01513 | 73.48601814 | 340.9503815 | 4.42543178 | 340.4515763 | 4.425376791 |
| no.21 | 420 | -5117.3155 | -16639.63676 | 73.42700817 | 344.5198096 | 15.57456822 | 342.7350956 | 15.57204976 |
| no.22 | 440 | -5097.848187 | -16644.1986 | 73.35195486 | 349.103472 | 20 | 346.8116408 | 19.9946671 |
| kae2 | 449.2289357 | -5088.755507 | -16645.77555 | 73.31759626 | 351.2185883 | 9.22893571 | 350.1610302 | 9.228411681 |
| kee2 | 457.3289357 | -5080.730432 | -16646.87141 | 73.28758343 | 353.3070195 | 8.1 | 352.2241284 | 8.099551232 |
| no.23 | 460 | -5078.075571 | -16647.16499 | 73.27771565 | 354.072223 | 2.67106429 | 353.6896212 | 2.671044434 |
| no.24 | 480 | -5058.112464 | -16648.23322 | 73.20429056 | 359.8018009 | 20 | 356.937012 | 19.99166771 |
| ke2-2 | 487.165115 | -5050.94848 | -16648.12967 | 73.17818367 | 1.854455181 | 7.16511502 | 0.828128017 | 7.164731853 |
| no.25 | 500 | -5038.140518 | -16647.32752 | 73.13167129 | 5.203650477 | 12.83488498 | 3.583677361 | 12.83305656 |
| no.26 | 520 | -5018.306162 | -16644.78932 | 73.05935121 | 9.116086019 | 20 | 7.292507664 | 19.99610383 |
| no.27 | 540 | -4998.636665 | -16641.17604 | 72.98703113 | 11.43697213 | 20 | 10.40916185 | 19.99862196 |
| ka2-2+ka3-1 | 559.165115 | -4979.885229 | -16637.21625 | 72.91772999 | 12.16769551 | 19.16511502 | 11.92412138 | 19.16497648 |
| no.28 | 560 | -4979.069099 | -16637.04028 | 72.91471105 | 12.1666767 | 0.83488498 | 12.16735578 | 0.834884991 |
| no.29 | 580 | -4959.502442 | -16632.90004 | 72.84239096 | 11.53321427 | 20 | 11.94738748 | 19.99989234 |
| no.30 | 600 | -4939.852902 | -16629.17682 | 72.77007088 | 9.730450217 | 20 | 10.72927566 | 19.99916923 |
| no.31 | 620 | -4920.066725 | -16626.27556 | 72.69305278 | 6.758384542 | 20 | 8.341863559 | 19.99775201 |
| ke3-1 | 629.165115 | -4910.950556 | -16625.33309 | 72.62953252 | 5.005723061 | 9.16511502 | 5.90251673 | 9.164757566 |
| no.32 | 640 | -4900.1414 | -16624.59673 | 72.51806296 | 2.788604568 | 10.83488498 | 3.897163798 | 10.83420899 |
| no.33 | 660 | -4880.14733 | -16624.33767 | 72.20877837 | 358.6960489 | 20 | 0.742326753 | 19.99574857 |
| no.34 | 680 | -4860.185754 | -16625.50621 | 71.76519901 | 354.6034932 | 20 | 356.649771 | 19.99574857 |
| no.35 | 700 | -4840.358476 | -16628.09638 | 71.18732489 | 350.5109375 | 20 | 352.5572154 | 19.99574857 |
| no.36 | 720 | -4820.76661 | -16632.09498 | 70.47985401 | 346.4183819 | 20 | 348.4646597 | 19.99574858 |
| ep | 730.297315 | -4810.803961 | -16634.69659 | 70.0969 | 344.3112651 | 10.29731497 | 345.3648235 | 10.29673468 |

- 縦断計算書 (xlsx)

| 縦断名 | 縦断線形1 | | | | |
|--------------|------------|-----------|-----------|-----------|-------|
| 測点 | 累加距離標 | 計画高 | 変化点高 | 縦距 | 縦断曲線長 |
| 0+00.000000 | 0 | 83.55004 | 83.55004 | 0 | |
| 1+00.000000 | 20 | 82.612318 | 82.612318 | 0 | |
| 2+00.000000 | 40 | 81.674595 | 81.674595 | 0 | |
| 3+00.000000 | 60 | 80.755361 | 80.736873 | 0.018488 | |
| 4+00.000000 | 80 | 79.885971 | 79.799151 | 0.08682 | |
| 4+12.862460 | 92.86246 | 79.353455 | 79.19608 | 0.157375 | 100 |
| 5+00.000000 | 100 | 79.066942 | 78.95129 | 0.115652 | |
| 6+00.000000 | 120 | 78.298272 | 78.265368 | 0.032904 | |
| 7+00.000000 | 140 | 77.579962 | 77.579447 | 0.000515 | |
| 8+00.000000 | 160 | 76.893525 | 76.893525 | 0 | |
| 9+00.000000 | 180 | 76.207603 | 76.207603 | 0 | |
| 10+00.000000 | 200 | 75.533546 | 75.521681 | 0.011865 | |
| 11+00.000000 | 220 | 74.962361 | 74.835759 | 0.126602 | |
| 12+00.000000 | 240 | 74.513083 | 74.149837 | 0.363246 | |
| 12+01.176153 | 241.176153 | 74.490457 | 74.1095 | 0.380957 | 100 |
| 13+00.000000 | 260 | 74.185711 | 74.037602 | 0.148109 | |
| 14+00.000000 | 280 | 73.980245 | 73.961211 | 0.019034 | |
| 15+00.000000 | 300 | 73.88482 | 73.88482 | 0 | |
| 16+00.000000 | 320 | 73.80843 | 73.80843 | 0 | |
| 17+00.000000 | 340 | 73.732039 | 73.732039 | 0 | |
| 18+00.000000 | 360 | 73.655649 | 73.655649 | 0 | |
| 19+00.000000 | 380 | 73.579258 | 73.579258 | 0 | |
| 20+00.000000 | 400 | 73.502876 | 73.502867 | 0.000009 | |
| 21+00.000000 | 420 | 73.427008 | 73.426477 | 0.000531 | |
| 22+00.000000 | 440 | 73.351955 | 73.350086 | 0.001869 | |
| 22+07.146436 | 447.146436 | 73.325334 | 73.32279 | 0.002544 | 100 |
| 23+00.000000 | 460 | 73.277716 | 73.276311 | 0.001405 | |
| 24+00.000000 | 480 | 73.204291 | 73.203991 | 0.0003 | |
| 25+00.000000 | 500 | 73.131671 | 73.131671 | 0 | |
| 26+00.000000 | 520 | 73.059351 | 73.059351 | 0 | |
| 27+00.000000 | 540 | 72.987031 | 72.987031 | 0 | |
| 28+00.000000 | 560 | 72.914711 | 72.914711 | 0 | |
| 29+00.000000 | 580 | 72.842391 | 72.842391 | 0 | |
| 30+00.000000 | 600 | 72.770071 | 72.770071 | 0 | |
| 31+00.000000 | 620 | 72.693053 | 72.697751 | -0.004698 | |
| 32+00.000000 | 640 | 72.518063 | 72.625431 | -0.107368 | |
| 33+00.000000 | 660 | 72.208778 | 72.553111 | -0.344333 | |
| 33+04.709793 | 664.709793 | 72.116409 | 72.53608 | -0.419671 | 100 |
| 34+00.000000 | 680 | 71.765199 | 71.967442 | -0.202243 | |
| 35+00.000000 | 700 | 71.187325 | 71.223648 | -0.036323 | |
| 36+00.000000 | 720 | 70.479854 | 70.479854 | 0 | |
| 36+10.297315 | 730.297315 | 70.0969 | 70.0969 | 0 | |

- 横断勾配計算書 (xlsx)

| 線形名 | oo路線-線形2 (主測点間隔20m、S型、卵型) | | |
|--------------|---------------------------|-----------|-----------|
| 測点 | 累加距離標 | 横断勾配 (左側) | 横断勾配 (右側) |
| 0+00.000000 | 0 | -2 | -2 |
| 1+00.000000 | 20 | -2 | 0 |
| 2+00.000000 | 40 | -2 | 2 |
| 3+00.000000 | 60 | -3.647059 | 3.647059 |
| 3+04.285714 | 64.285714 | -4 | 4 |
| 4+00.000000 | 80 | -4 | 4 |
| 5+00.000000 | 100 | -4 | 4 |
| 6+00.000000 | 120 | -4 | 4 |
| 7+00.000000 | 140 | -4 | 4 |
| 8+00.000000 | 160 | -4 | 4 |
| 9+00.000000 | 180 | -4 | 4 |
| 10+00.000000 | 200 | -4 | 4 |
| 11+00.000000 | 220 | -4 | 4 |
| 12+00.000000 | 240 | -4 | 4 |
| 12+10.139717 | 250.139717 | -4 | 4 |
| 13+00.000000 | 260 | -3 | 1.6885 |
| 14+00.000000 | 280 | -2 | -3 |
| 15+00.000000 | 300 | -1 | -2 |
| 16+00.000000 | 320 | 0.55 | -1 |
| 16+18.711146 | 338.711146 | 2 | -2 |
| 17+00.000000 | 340 | 1.878917 | -1.848647 |
| 18+00.000000 | 360 | 0 | 0.5 |
| 19+00.000000 | 380 | 1 | -1.5 |
| 20+00.000000 | 400 | 2 | -2.5 |
| 20+04.425431 | 404.425431 | 5 | -5 |
| 21+00.000000 | 420 | 5 | -5 |
| 22+00.000000 | 440 | 5 | -5 |
| 22+09.228936 | 449.228936 | 5 | -5 |
| 22+17.328936 | 457.328936 | 6 | -6 |
| 23+00.000000 | 460 | 6 | -6 |
| 24+00.000000 | 480 | 6 | -6 |
| 24+07.165115 | 487.165115 | 6 | -6 |
| 25+00.000000 | 500 | 5.106432 | -5.106432 |
| 26+00.000000 | 520 | 3.714027 | -3.714027 |
| 27+00.000000 | 540 | 2.321622 | -2.321622 |
| 27+04.619660 | 544.619660 | 2 | -2 |
| 28+00.000000 | 560 | 0.461966 | -0.461966 |
| 29+00.000000 | 580 | -1.538034 | 1.538034 |
| 29+04.619660 | 584.619660 | -2 | 2 |
| 30+00.000000 | 600 | -3.035819 | 3.035819 |
| 31+00.000000 | 620 | -4.382758 | 4.382758 |
| 31+09.165115 | 629.165115 | -5 | 5 |
| 32+00.000000 | 640 | -5 | 5 |
| 33+00.000000 | 660 | -5 | 5 |
| 34+00.000000 | 680 | -5 | 5 |
| 35+00.000000 | 700 | -5 | 5 |
| 36+00.000000 | 720 | -5 | 5 |
| 36+10.297315 | 730.297315 | -5 | 5 |

【図面作成】

• 平面図／線形図

- 平面線形データより、CAD 上に平面図（平面線形、旗揚げ（主要点）、主測点、副測点、幅杭）を作成

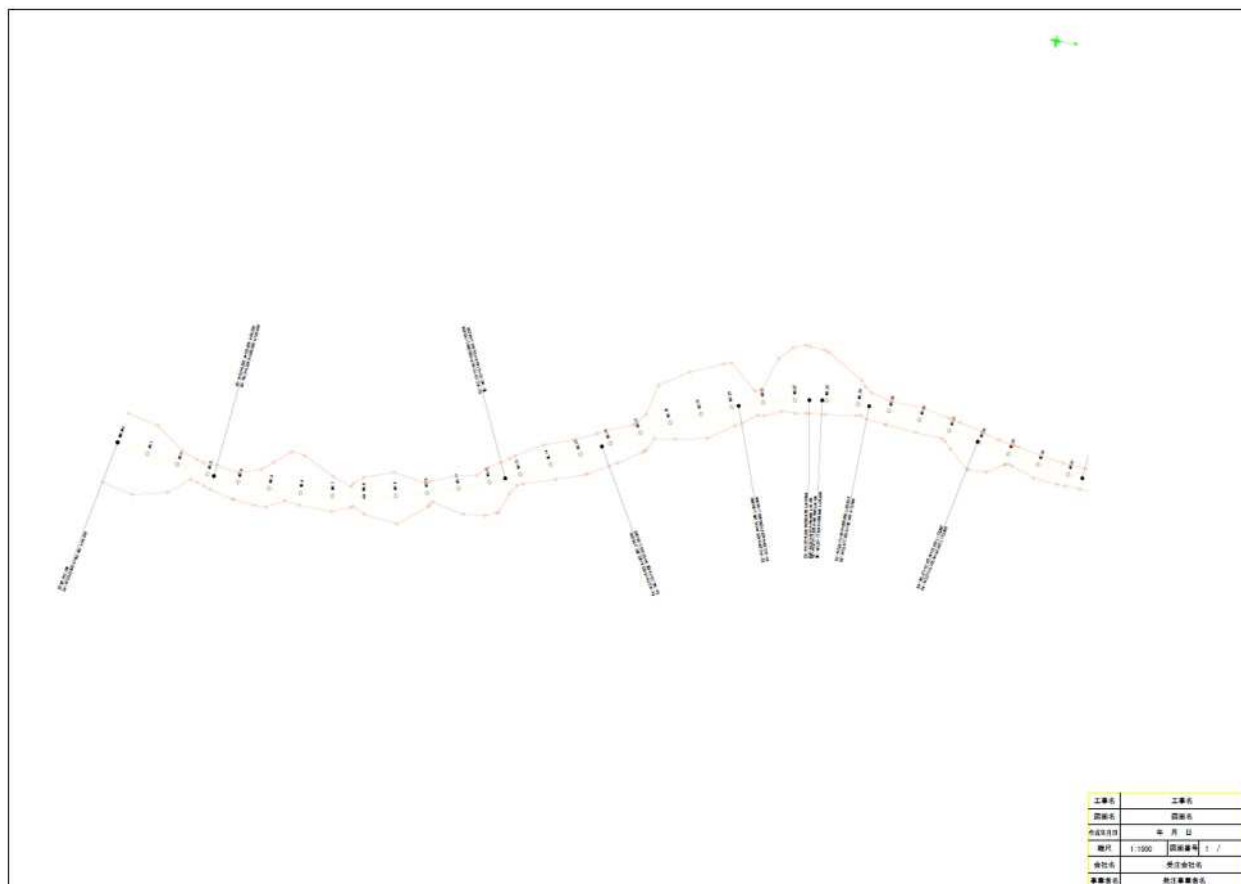

- 横断図

- 現況／計画横断データより、CAD 上に横断図（横断名、現況横断、計画横断、標高）を作成

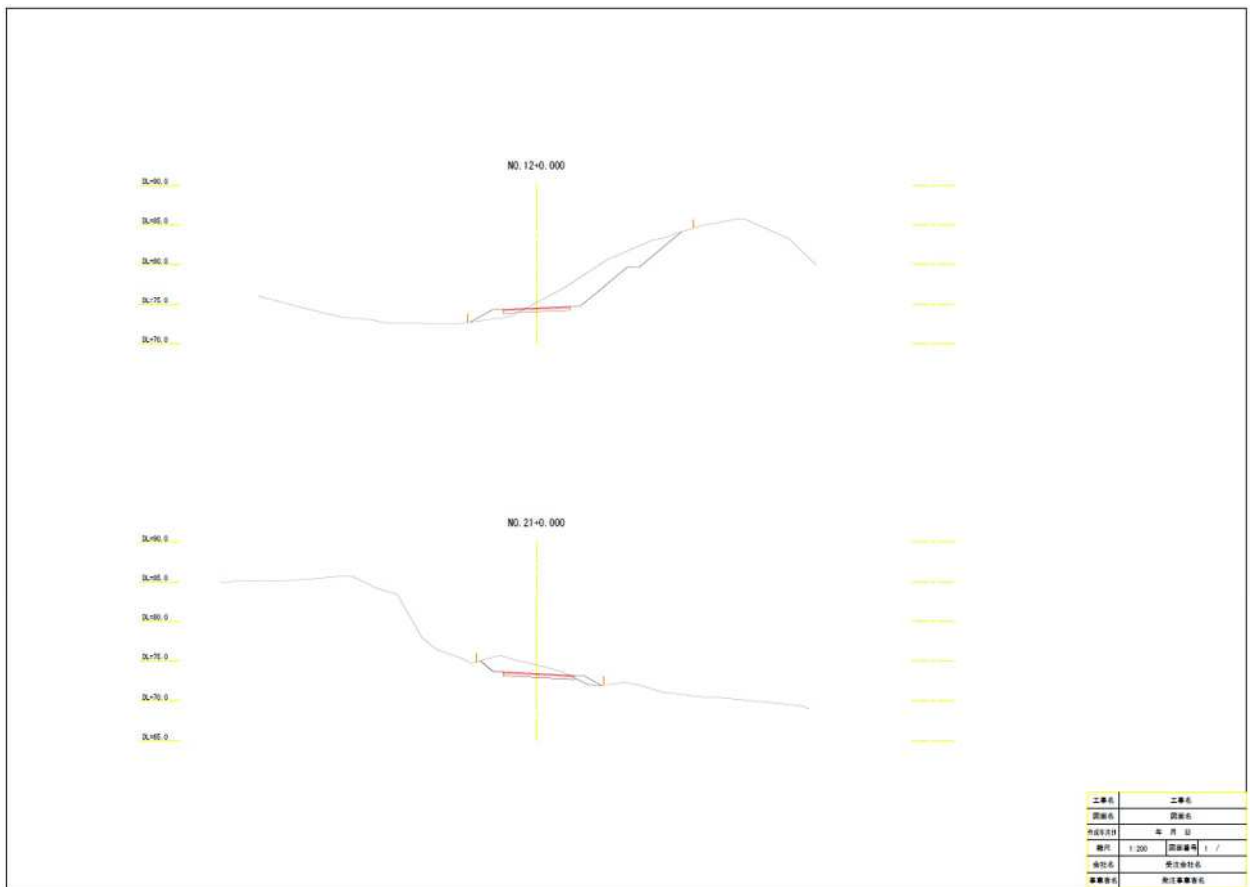

【3次元表示】

- スケルトン: 計画縦断、計画横断

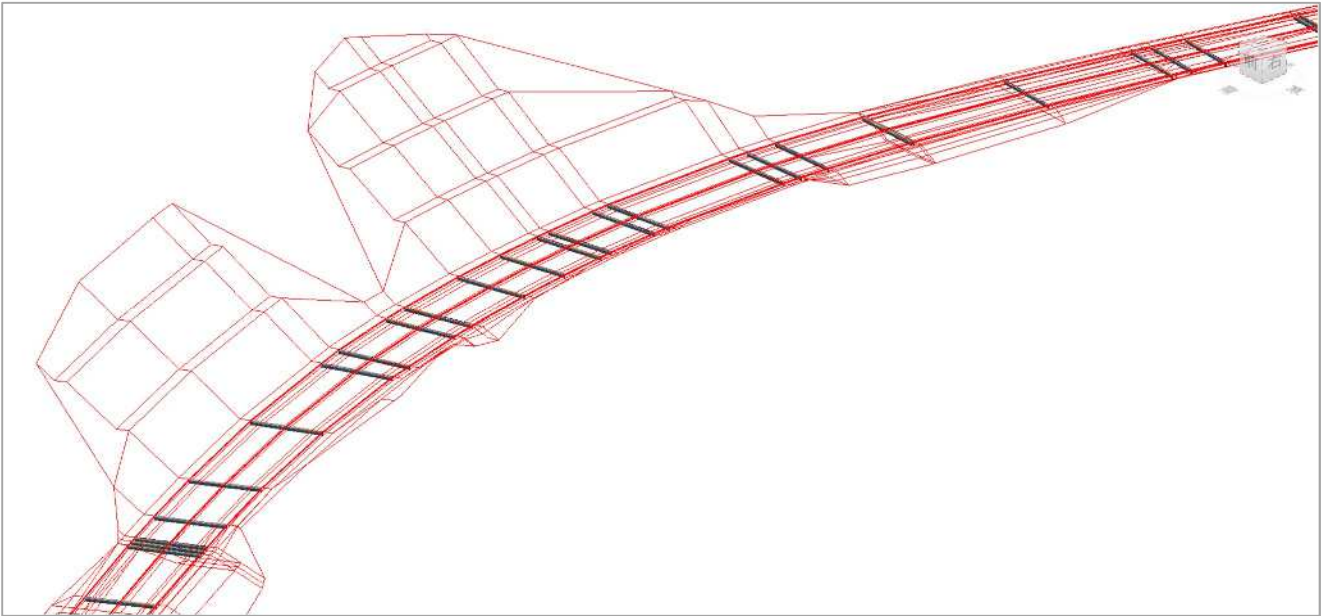

- サーフェス: 現況地形面、計画面(道路面、路床面、路体面) ※下記は道路面の例

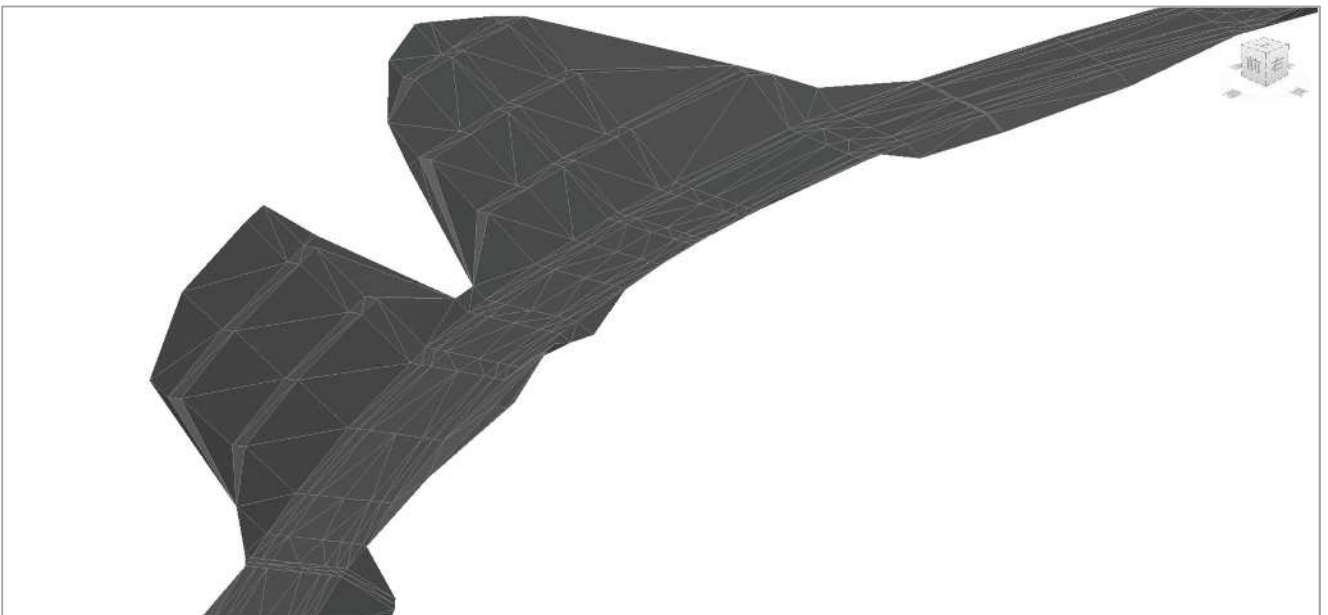

【2次元表示】

• 平面線形

- 平面線形データより、CAD上に平面図（平面線形、旗揚げ（主要点）、主測点、副測点）を作成

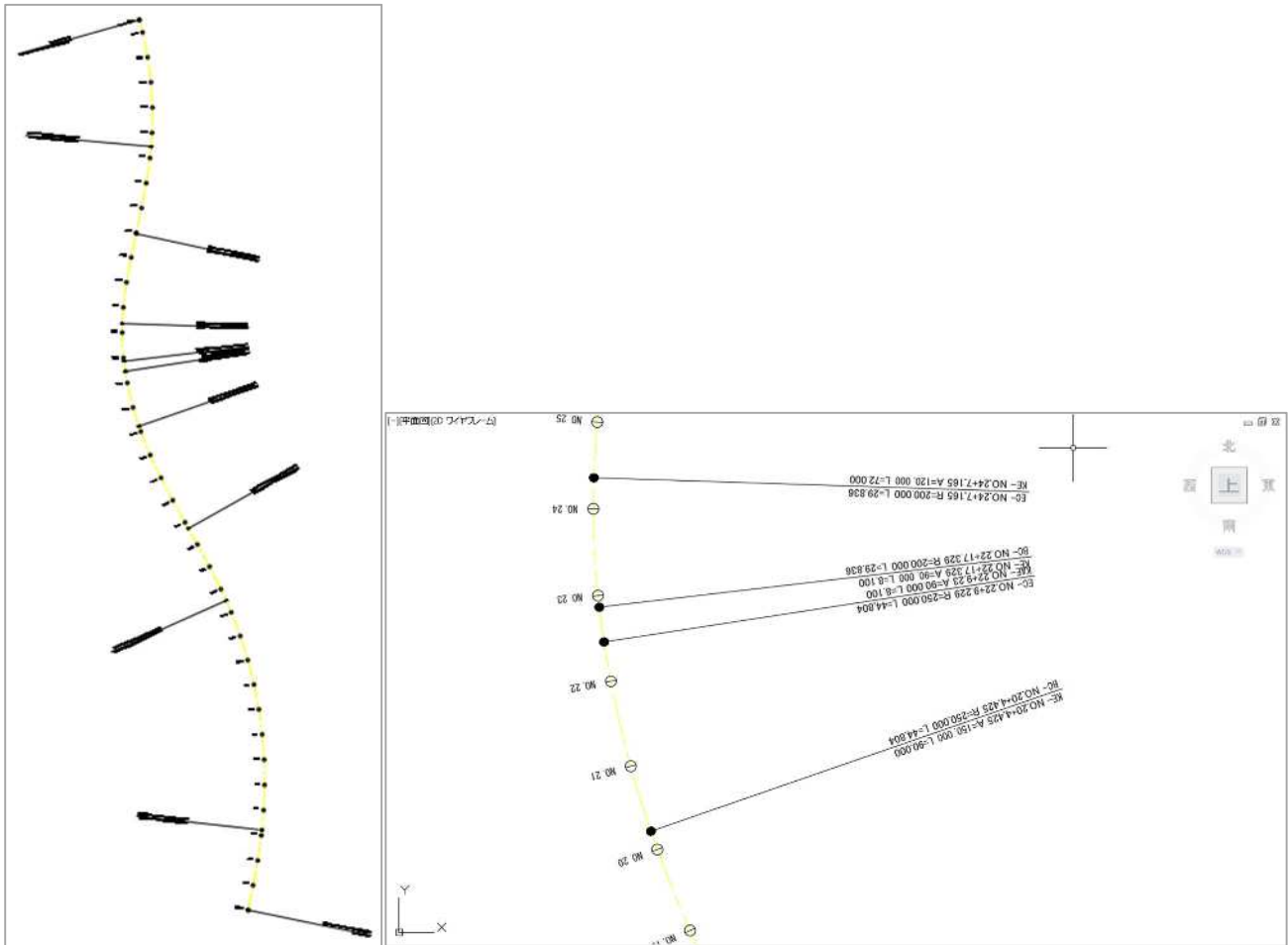

- 平面線形の諸元を表示、編集が可能（詳細は「データ編集」を参照）

- 縦断線形／縦断地盤線

- 現況／計画縦断データより、CAD 上に縦断図（縦断線形、縦断地盤線、帯（勾配、計画高、地盤高、切土高、盛土高、累加距離、単距離、測点、片勾配擦り付け）を作成

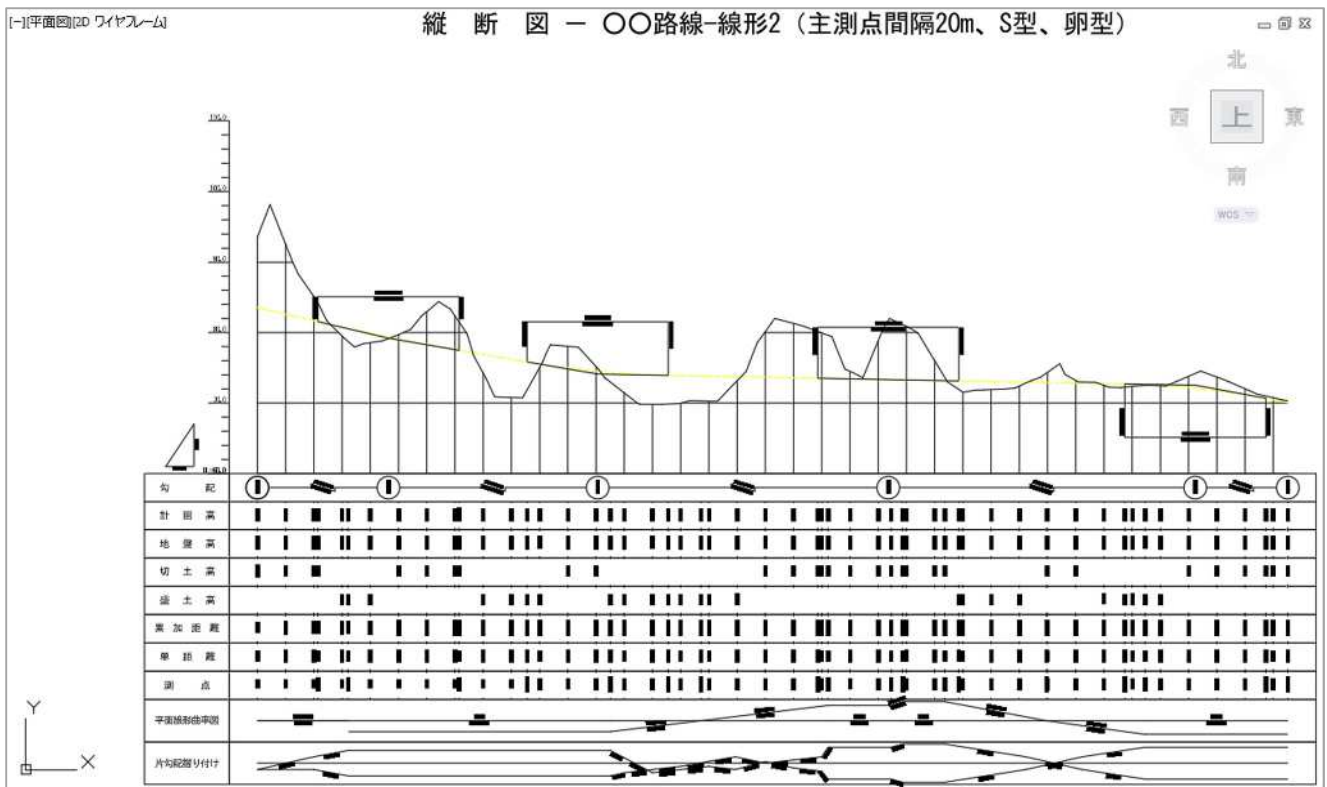

- 縦断線形／縦断地盤線の諸元を表示、編集が可能（詳細は「データ編集」を参照）

- 横断形状セット

- 現況／計画横断データより、CAD 上に横断図（横断名、現況横断、計画横断、標高）を作成

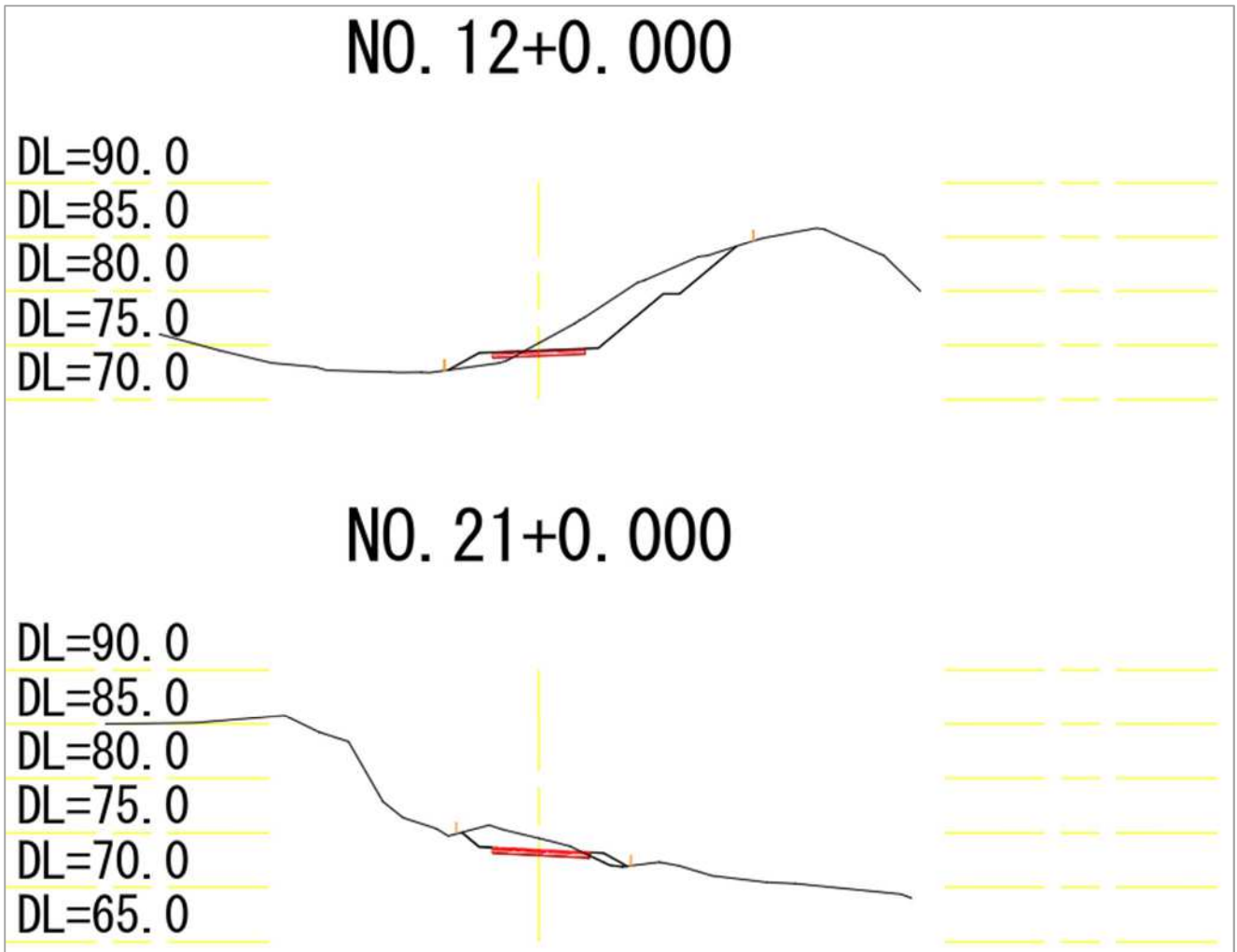

- 座標点

- 測点と測点名称を表示

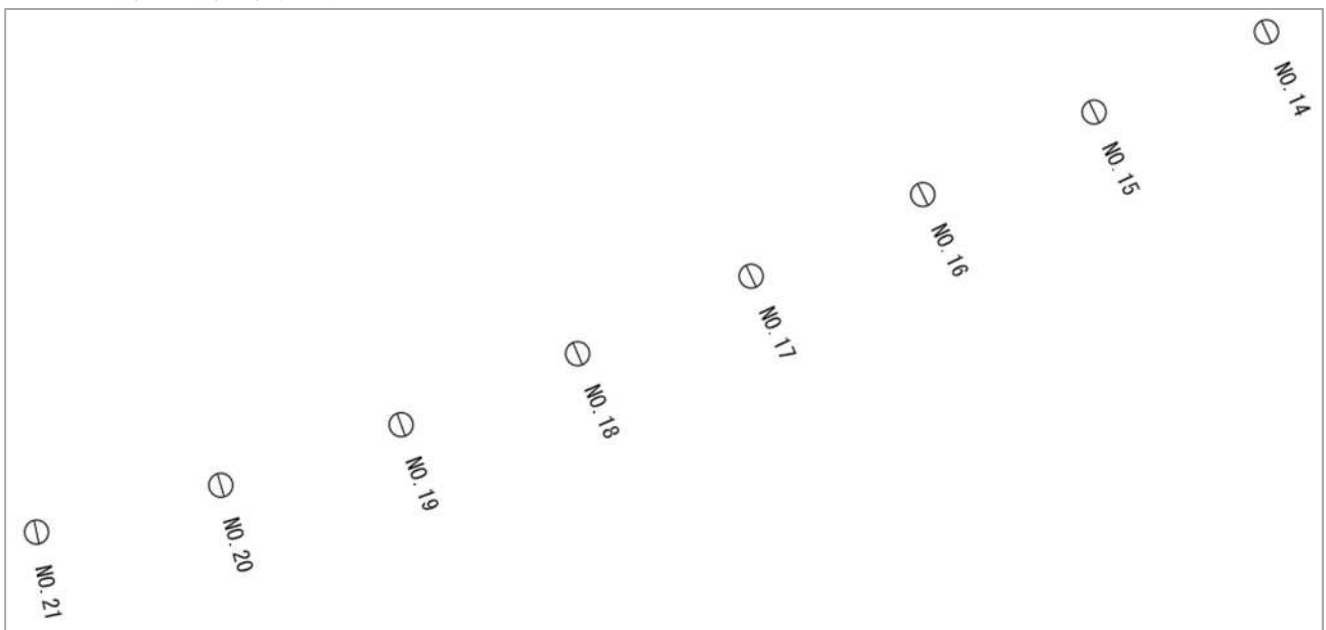

【管理情報表示】

Application や Project に関する情報（図面プロパティ）

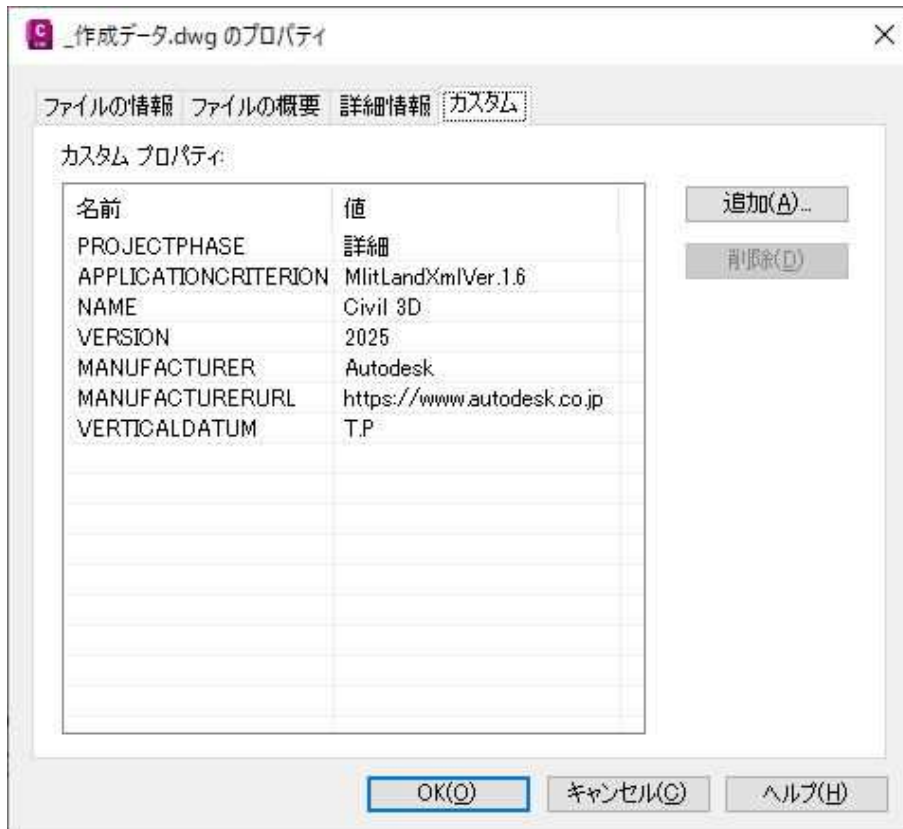

CoordinateSystem に関する情報（図面設定）

